

Explosion Proof Beacon GTL-200L

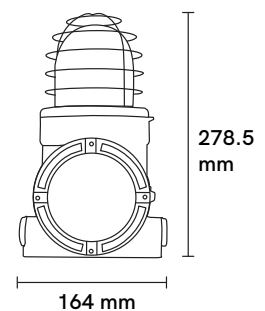

Specifications

- ✓ Red and yellow LED colours
- ✓ Sturdy Metal Construction
- ✓ 24 VDC
- ✓ Weight 5 kg.
- ✓ Conduct connection NPT (3/4" standard feature)
- ✓ Ex dIIC T6..T4Gb



Contact us > 07 4613 5111 - sales@gasdetect.com.au